

## BRASS CHECK VALVE WITH STRAINER BASKET

ISO 9001 : 2015

**BUREAU VERITAS**  
Certification



**Size :** DN 1/2" to 4"

**Ends :** Female BSP

**Min Temperature :** + 0°C

**Max Temperature :** + 90°C

**Max Pressure :** 10 Bars ( up to DN 1" )

**Specifications :** Vertical position

Brass strainer

Brass disc with NBR gasket

**Materials :** Brass body CW617N

## BRASS CHECK VALVE WITH STRAINER BASKET

### SPECIFICATIONS :

- Respect the flow direction indicated by the arrow
- Vertical position with ascendant fluid
- Threaded cylindrical female BSP ends
- Brass disc with NBR gasket
- Brass body and strainer CW617N for a better strength mechanical

### USE :

- Water distribution
- Min Temperature Ts : + 0°C
- Max Temperature Ts : + 90°C
- Max Pressure Ps : 10 bars up to DN 1" , 8 bars from 1"1/4 to 2" and 6 bars over

### RANGE :

- Threaded cylindrical BSP ends from DN 1/2" to DN 4"

### MATERIALS :

DN 1/2" and DN 2"1/2 to 4"

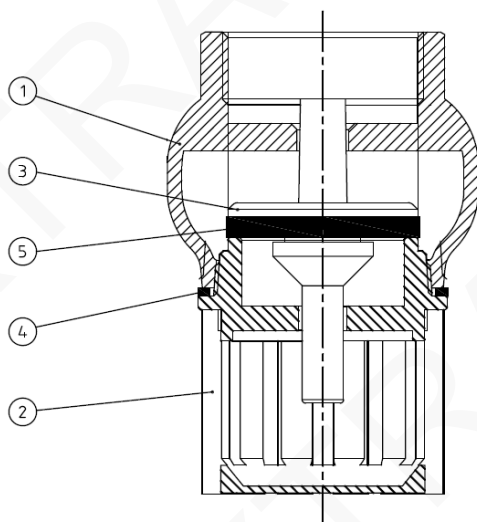

DN 3/4" to 2"

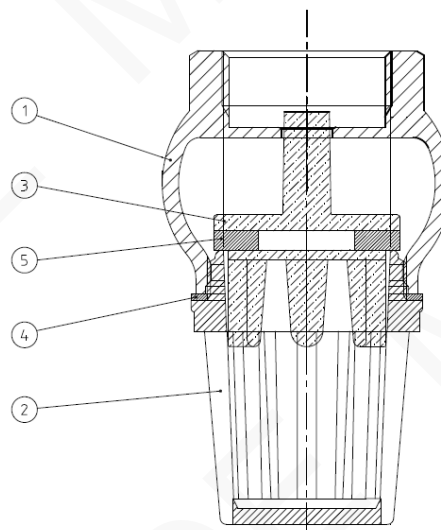

Item	Designation	Materials
1	Body	Brass CW 617 N according to EN 12165
2	Strainer	Brass CW 617 N according to EN 12165
3	Disc	Brass CW 617 N according to EN 12165
4	Gasket	Fibers
5	Gasket	NBR

## BRASS CHECK VALVE WITH STRAINER BASKET

SIZE ( in mm ) :

DN 1/2"

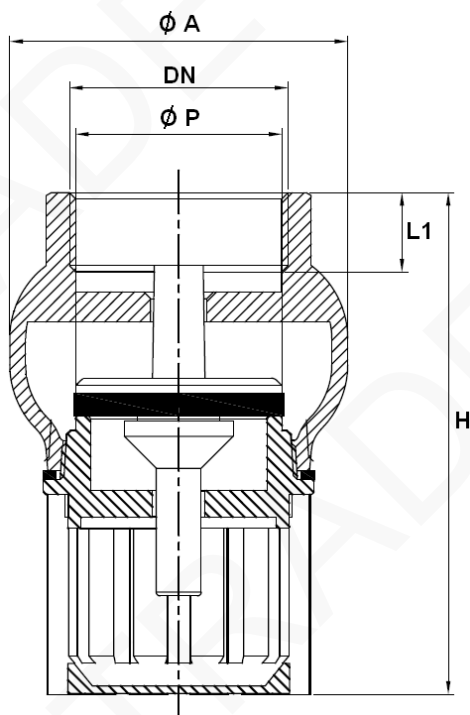

DN 3/4" to 2"

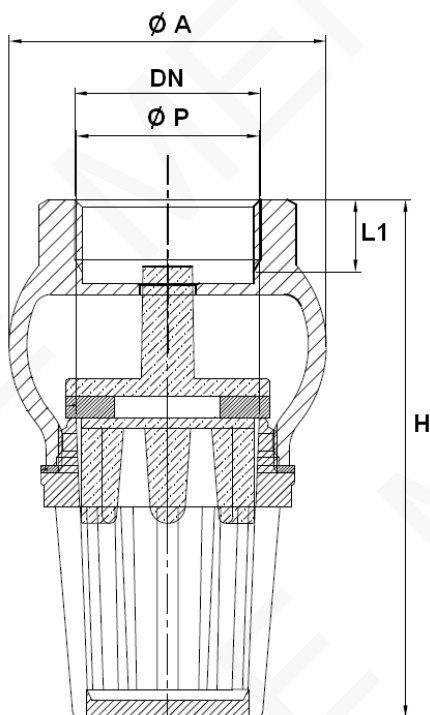

DN 2 1/2 to 4"

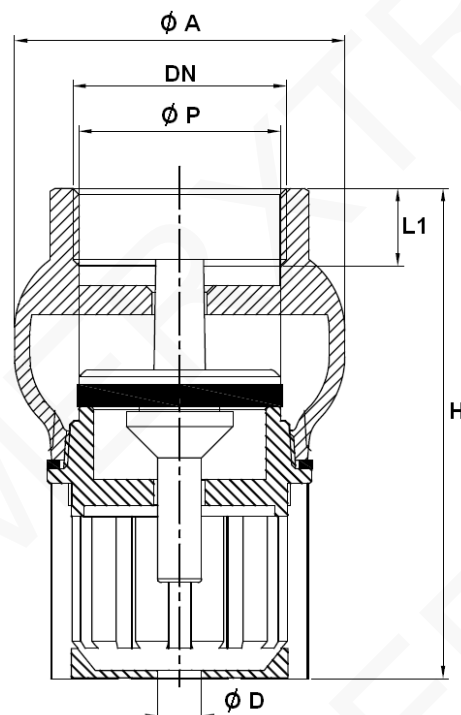

Ref.	DN	1/2"	3/4"	1"	1 1/4"	1 1/2"	2"	2 1/2"	3"	4"
<b>304</b>	Ø A	39	45	51	61	68	80	103	115	145
	Ø D	-	-	-	-	-	-	11	11	12
	Ø P	18	23	28	34	41	51	62	73	93
	L1	10	10	12	13	13	15	12	15	22
	H	60	73	81	95	103	121	136	151	187
	Mesh	2	3	3	3	3	4	5	5	5
	Weight ( Kg )	0.159	0.254	0.324	0.504	0.590	1.025	1.353	1.724	3.256

## BRASS CHECK VALVE WITH STRAINER BASKET

### STANDARDS :

- Fabrication according to ISO 9001:2015
- DIRECTIVE 2014/68/EU : Products excluded from directive ( Article 1, § 2b )
- Threaded cylindrical female BSP ends according to ISO 228-1

### INSTALLATION POSITIONS :

Vertical position ( ascendant fluid )



**ADVICE :** Our opinion and our advice are not guaranteed and MXT shall not be liable for the consequences of damages. The customer must check the right choice of the products with the real service conditions.

## BRASS CHECK VALVE WITH STRAINER BASKET

### INSTALLATION INSTRUCTIONS

#### GENERAL GUIDELINES :

- Ensure that the check valves to be used are appropriate for the conditions of the installation (type of fluid, pressure and temperature).
- Be sure to have enough valves to be able to isolate the sections of piping as well as the appropriate equipment for maintenance and repair.
- Ensure that the valves to be installed are of correct strength to be able to support the capacity of their usage.

#### INSTALLATION INSTRUCTIONS :

- **Before installing the check valves, clean and remove any objects from the pipes** (in particular bits of sealing and metal) which could obstruct and block the valves.
- **Ensure that both connecting pipes either side of the check valve (upstream and downstream) are aligned (if they're not, the valves may not work correctly).**
- **Make sure that the two sections of the pipe (upstream and downstream) match, the check valve unit will not absorb any gaps. Any distortions in the pipes may affect the tightness of the connection, the working of the check valve and can even cause a rupture.** To be sure, place the kit in position to ensure the assembling will work.
- Before starting the fitting, ensure that the threads and tapping are clean.
- **If sections of piping do not have their final support in place, they should be temporarily fixed. This is to avoid unnecessary strain on the check valve.**
- The theoretical lengths given by ISO/R7 for the tapping are typically longer than required, the length of the thread should be limited, and **check that the end of the tube does not press right up to the head of the thread.**
- When screwing the check valve, ensure that you only rotate on the screwed side by the 6 ended side. Use an open ended spanner or an adjustable spanner and not a monkey wrench.
- **Never use a vice to tighten the fixings of the check valve.**
- Do not over tighten the check valve. Do not block with any extensions as it may cause a rupture or weakening of the casing.
- **In general, for all check valves used in buildings and heating, do not tighten above a torque of 30 Nm.**
- If there is a direction changing or if there's another material, it's better to take away the check valve so that it is outside the turbulence area ( **between 3 and 5 times the ND before and after** ).
- After a pump please refer to norm NF CR 13932 to install the check valve.